

- Pipe 5m lengths
- Extruded

**PIPE**

Size		Dimensions					Part Number
mm	inch	SDR	MOP (psi)	da(OD) (in)	s (in)	Weight (lbs/ft)	
20	1/2	7.4	230	0.79	0.11	0.10	5802005
25	3/4	7.4	230	0.98	0.14	0.16	5802007
32	1	7.4	230	1.26	0.17	0.26	5802010
40	1-1/4	7.4	230	1.57	0.22	0.41	5802012
50	1-1/2	7.4	230	1.97	0.27	0.64	5802015
63	2	7.4	230	2.48	0.34	1.00	5802020
90	3	7.4	230	3.54	0.48	2.04	5802030
110	4	7.4	230	4.33	0.59	3.05	5802040
160	6	11	150	6.30	0.57	4.53	580211060
200	8	11	150	7.87	0.72	7.06	580211080
250	10	11	150	9.84	0.89	10.95	580211100
315	12	11	150	12.40	1.13	17.40	580211120

Note: Socket fusion couplings are required between components rated SDR 11 and SDR 7.4. Butt fusion only permitted where component SDR matches.

*The most current up-to-date drawings and CAD models can be found at <https://cad.asahi-america.com/>*

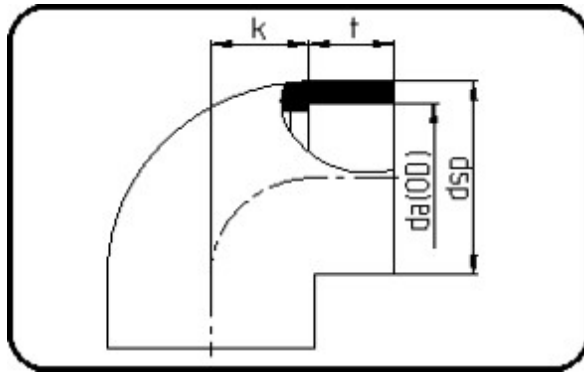

- Elbow 90°
- Injection molded
- Socket welding

### 90 DEGREE ELBOW

Size		Dimensions							Part Number
mm	inch	SDR	MOP (psi)	da(OD) (in)	dsp (in)	t (in)	k (in)	Weight (lbs)	
20	1/2	7.4	230	0.79	1.15	0.63	0.55	0.05	5805005
25	3/4	7.4	230	0.98	1.38	0.71	0.67	0.07	5805007
32	1	7.4	230	1.26	1.70	0.77	0.79	0.11	5805010
40	1-1/4	7.4	230	1.57	2.10	0.85	0.98	0.19	5805012
50	1-1/2	7.4	230	1.97	2.56	0.98	1.10	0.31	5805015
63	2	7.4	230	2.48	3.21	1.20	1.38	0.59	5805020
90	3	7.4	230	3.54	4.33	1.44	1.81	1.12	5805030
110	4	7.4	230	4.33	5.24	1.69	2.24	1.80	5805040

The most current up-to-date drawings and CAD models can be found at <https://cad.asahi-america.com/>

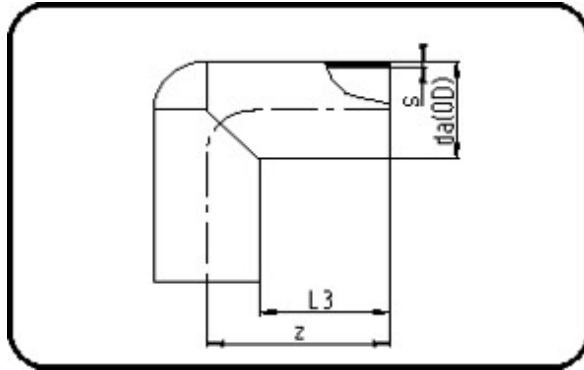

- Elbow 90°
- Long spigot
- Injection molded
- Butt & electrofusion welding

### 90 DEGREE SWEEP ELBOW

Size		Dimensions							Part Number
mm	inch	SDR	MOP (psi)	da(OD) (in)	s (in)	z (in)	L3 (in)	Weight (lbs)	
63	2	7.4	230	2.48	0.34	4.29	2.99	0.68	580501020
90	3	7.4	230	3.54	0.48	4.96	3.25	1.66	580501030
110	4	7.4	230	4.33	0.59	5.73	3.46	2.78	580501040

*The most current up-to-date drawings and CAD models can be found at <https://cad.asahi-america.com/>*

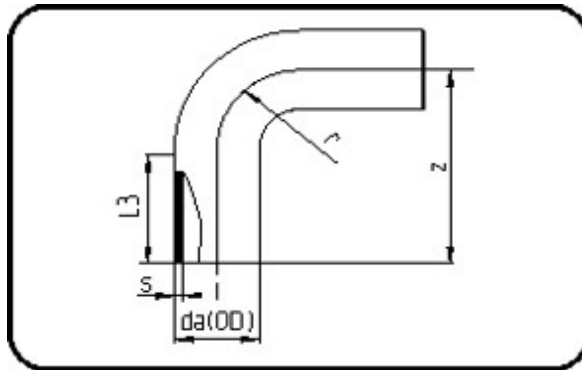

- Elbow 90°
- Long spigot
- Injection molded
- Butt & electrofusion welding

**ELONGATED 90 DEGREE ELBOW**

Size		Dimensions								Part Number
mm	inch	SDR	MOP (psi)	da(OD) (in)	s (in)	z (in)	r (in)	L3 (in)	Weight (lbs)	
160	6	11	150	6.30	0.57	10.24	6.30	3.96	7.29	5811060
200	8	11	150	7.87	0.72	12.54	7.87	4.67	13.49	5811080
250	10	11	150	9.84	0.89	15.31	9.84	5.24	23.81	5811100
280	11	11	150	11.02	1.00	16.89	11.02	5.63	33.29	5811110
315	12	11	150	12.40	1.13	18.70	12.40	6.22	46.34	5811120

Note: Socket fusion couplings are required between components rated SDR 11 and SDR 7.4. Butt fusion only permitted where component SDR matches.

*The most current up-to-date drawings and CAD models can be found at <https://cad.asahi-america.com/>*

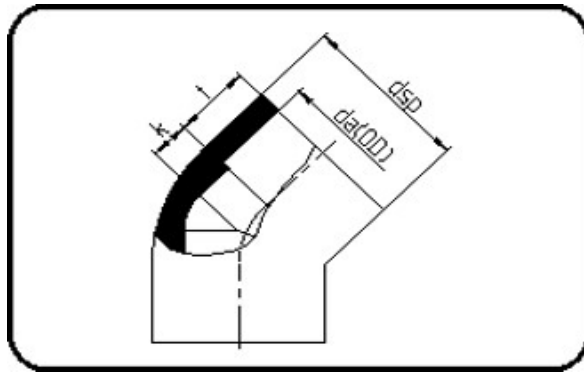

- Elbow 45°
- Injection molded
- Socket welding

**45 DEGREE ELBOW**

Size		Dimensions							Part Number
mm	inch	SDR	MOP (psi)	da(OD) (in)	dsp (in)	t (in)	k (in)	Weight (lbs)	
20	1/2	7.4	230	0.79	1.14	0.65	0.31	0.04	5808005
25	3/4	7.4	230	0.98	1.38	0.71	0.37	0.06	5808007
32	1	7.4	230	1.26	1.69	0.79	0.41	0.09	5808010
40	1-1/4	7.4	230	1.57	2.09	0.87	0.49	0.15	5808012
50	1-1/2	7.4	230	1.97	2.56	0.94	0.59	0.23	5808015
63	2	7.4	230	2.48	3.19	1.14	0.73	0.40	5808020
75	2-1/2	7.4	230	2.95	3.62	1.30	0.79	0.54	5808025
90	3	7.4	230	3.54	4.45	1.44	0.93	1.00	5808030
110	4	7.4	230	4.33	5.31	1.69	1.10	1.46	5808040

*The most current up-to-date drawings and CAD models can be found at <https://cad.asahi-america.com/>*

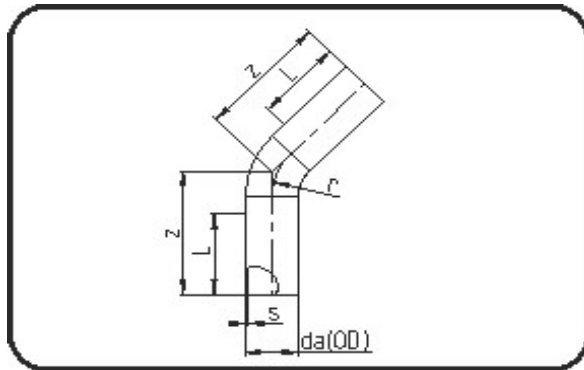

- Sweep bend 45°
- Radius 1.5 x OD
- Formed out of pipe
- Butt & electrofusion welding

**45 DEGREE SWEEP ELBOW**

Size		Dimensions								Part Number
mm	inch	SDR	MOP (psi)	da(OD) (in)	s (in)	z (in)	r (in)	L (in)	Weight (lbs)	
63	2	7.4	230	2.48	0.34	6.69	3.74	3.94	0.57	580801020
90	3	7.4	230	3.54	0.32	13.78	5.31	5.91	1.50	580801030
110	4	7.4	230	4.33	0.39	13.39	6.50	5.91	2.48	580801040

*The most current up-to-date drawings and CAD models can be found at <https://cad.asahi-america.com/>*

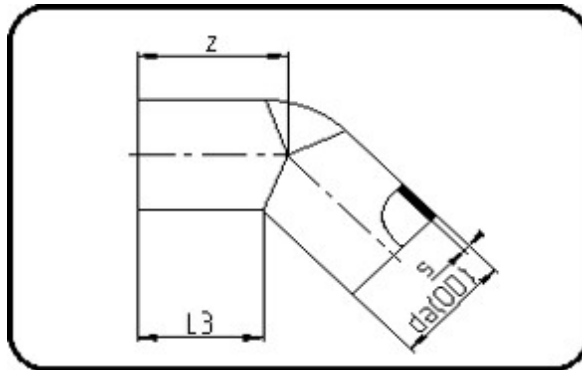

- Elbow 45°
- Long spigot
- Injection molded
- Butt & electrofusion welding

**ELONGATED 45 DEGREE ELBOW**

Size		Dimensions							Part Number
mm	inch	SDR	MOP (psi)	da(OD) (in)	s (in)	z (in)	L3 (in)	Weight (lbs)	
160	6	11	150	6.30	0.57	5.91	4.59	4.48	5809060
180	7	11	150	7.09	0.65	6.30	4.65	5.82	5809070
200	8	11	150	7.87	0.72	6.81	5.10	8.07	5809080
250	10	11	150	9.84	0.89	8.54	6.22	15.79	5809100
280	11	11	150	11.02	1.00	9.37	6.61	21.21	5809110
315	12	11	150	12.40	1.13	9.76	6.93	28.46	5809120

Note: Socket fusion couplings are required between components rated SDR 11 and SDR 7.4. Butt fusion only permitted where component SDR matches.

*The most current up-to-date drawings and CAD models can be found at <https://cad.asahi-america.com/>*

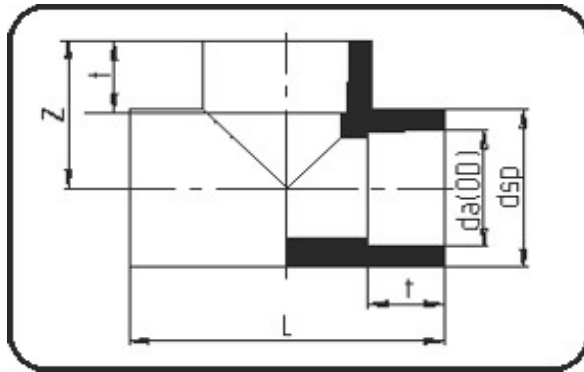

- Tee
- Injection molded
- Socket welding

### TEE - SOCKET

Size		Dimensions								Part Number
mm	inch	SDR	MOP (psi)	da(OD) (in)	L (in)	dsp (in)	t (in)	z (in)	Weight (lbs)	
20	1/2	7.4	230	0.79	2.36	1.15	0.63	1.18	0.06	5820005
25	3/4	7.4	230	0.98	2.76	1.39	0.71	1.38	0.10	5820007
32	1	7.4	230	1.26	3.13	1.69	0.77	1.57	0.15	5820010
40	1-1/4	7.4	230	1.57	3.62	2.09	0.87	1.81	0.24	5820012
50	1-1/2	7.4	230	1.97	4.23	2.56	0.96	2.13	0.40	5820015
63	2	7.4	230	2.48	5.06	3.19	1.14	2.50	0.65	5820020
75	2-1/2	7.4	230	2.95	5.98	3.66	1.28	2.80	1.01	5820025
90	3	7.4	230	3.54	7.20	4.49	1.44	3.46	1.76	5820030
110	4	7.4	230	4.33	8.11	5.30	1.69	4.00	2.47	5820040

*The most current up-to-date drawings and CAD models can be found at <https://cad.asahi-america.com/>*



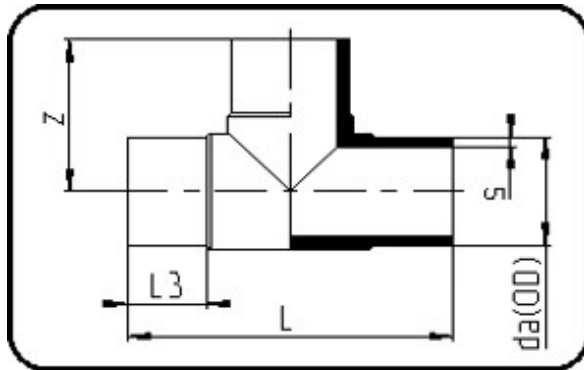

- Tee
- Long spigot
- Injection molded
- Butt & electrofusion welding

### TEE - BUTT

Size		Dimensions								Part Number
mm	inch	SDR	MOP (psi)	da(OD) (in)	s (in)	z (in)	L (in)	L3 (in)	Weight (lbs)	
63	2	7.4	230	2.48	0.34	4.37	8.62	2.48	1.08	582001020
90	3	7.4	230	3.54	0.48	5.55	11.18	3.11	2.81	582001030
110	4	7.4	230	4.33	0.59	6.22	12.40	3.23	4.59	582001040

*The most current up-to-date drawings and CAD models can be found at <https://cad.asahi-america.com/>*

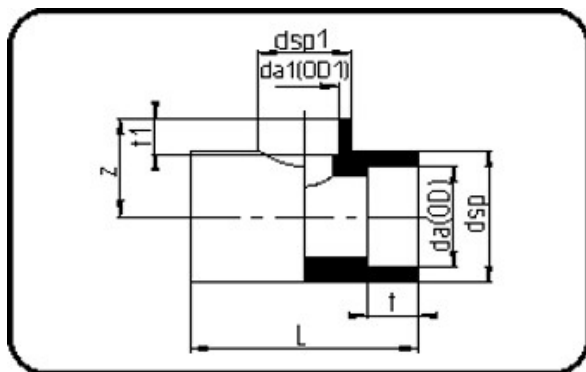

- Reducing tee
- Injection molded
- Socket welding

### REDUCING TEE - SOCKET

Size		Dimensions											Part Number
mm	inch	SDR	MOP (psi)	da(OD) (in)	da(OD1) (in)	z (in)	L (in)	dsp (in)	dsp1 (in)	t (in)	t1 (in)	Weight (lbs)	
25 x 20	3/4 x 1/2	7.4	230	0.98	0.79	1.40	2.76	1.37	1.38	0.71	0.63	0.11	5824101
32 x 20	1 x 1/2	7.4	230	1.26	0.79	1.57	3.14	1.69	1.18	0.77	0.63	0.14	5824130
32 x 25	1 x 3/4	7.4	230	1.26	0.98	1.57	3.11	1.69	1.38	0.77	0.71	0.14	5824131
40 x 20	1-1/4 x 1/2	7.4	230	1.57	0.79	1.81	3.58	2.09	1.18	0.87	0.59	0.22	5824166
40 x 25	1-1/4 x 3/4	7.4	230	1.57	0.98	1.84	3.62	2.09	1.39	0.87	0.65	0.23	5824167
40 x 32	1-1/4 x 1	7.4	230	1.57	1.26	1.77	3.58	2.09	1.69	0.87	0.77	0.23	5824168
50 x 20	1-1/2 x 1/2	7.4	230	1.97	0.79	1.97	4.23	2.56	1.18	0.94	0.59	0.35	5824208
50 x 25	1-1/2 x 3/4	7.4	230	1.97	0.98	2.01	4.23	2.56	1.40	0.94	0.65	0.34	5824210
50 x 32	1-1/2 x 1	7.4	230	1.97	1.26	2.13	4.23	2.56	1.69	0.94	0.75	0.37	5824211
50 x 40	1-1/2 x 1-1/4	7.4	230	1.97	1.57	2.07	4.23	2.56	2.09	0.94	0.87	0.38	5824212
63 x 25	2 x 3/4	7.4	230	2.48	0.98	2.56	5.06	3.15	1.42	1.14	0.71	0.62	5824248
63 x 32	2 x 1	7.4	230	2.48	1.26	2.56	5.10	3.19	1.71	1.14	0.79	0.65	5824249
63 x 40	2 x 1-1/4	7.4	230	2.48	1.57	2.56	5.10	3.19	2.09	1.14	0.87	0.64	5824250
63 x 50	2 x 1-1/2	7.4	230	2.48	1.97	2.56	5.10	3.19	2.60	1.14	0.94	0.66	5824251

The most current up-to-date drawings and CAD models can be found at <https://cad.asahi-america.com/>

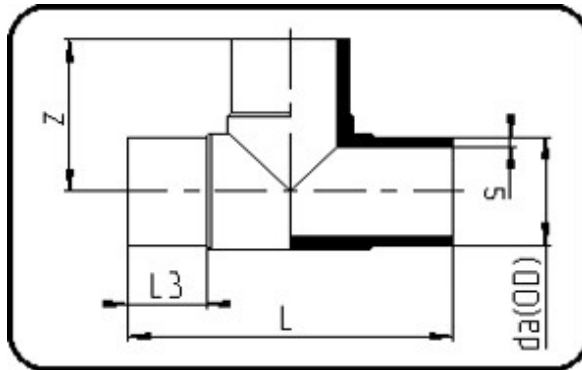

- Tee
- Long spigot
- Injection molded
- Butt & electrofusion welding

**ELONGATED TEE**

Size		Dimensions								Part Number
mm	inch	SDR	MOP (psi)	da(OD) (in)	s (in)	z (in)	L (in)	L3 (in)	Weight (lbs)	
160	6	11	150	6.30	0.57	7.97	15.94	3.90	8.91	5823060
200	8	11	150	7.87	0.72	9.65	19.29	4.41	17.46	5823080
250	10	11	150	9.84	0.89	12.20	24.21	5.79	33.20	5823100
315	12	11	150	12.40	1.13	14.76	29.61	6.61	62.74	5823120

Note: Socket fusion couplings are required between components rated SDR 11 and SDR 7.4. Butt fusion only permitted where component SDR matches.

*The most current up-to-date drawings and CAD models can be found at <https://cad.asahi-america.com/>*

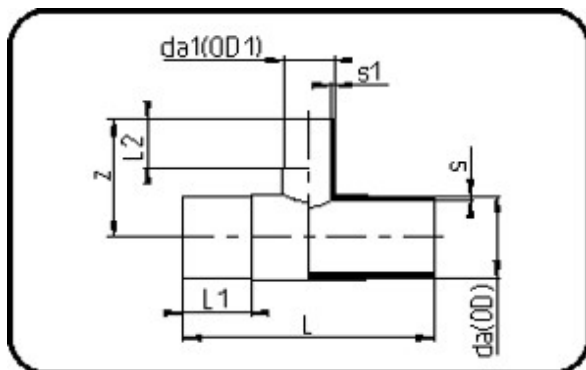

- Reducing tee
- Long spigot
- Injection molded
- Butt & electrofusion welding

### REDUCING TEE

Size		Dimensions											Part Number
mm	inch	SDR	MOP (psi)	da(OD) (in)	da(OD1) (in)	s (in)	z (in)	L (in)	L1 (in)	L2 (in)	s1 (in)	Weight (lbs)	
160 x 63	6 x 2	11	150	6.30	2.48	0.57	6.77	13.39	3.92	2.60	0.23	5.78	5825530
160 x 90	6 x 3	11	150	6.30	3.54	0.57	6.97	13.50	3.98	3.15	0.32	5.82	5825531
160 x 110	6 x 4	11	150	6.30	4.33	0.57	7.72	15.43	3.86	3.33	0.39	7.19	5825532
200 x 63	8 x 2	11	150	7.87	2.48	0.72	8.90	21.77	5.28	3.23	0.23	15.74	5825581
200 x 90	8 x 3	11	150	7.87	3.54	0.72	9.02	21.65	5.30	3.78	0.32	15.79	5825582
200 x 110	8 x 4	11	150	7.87	4.33	0.72	9.53	21.65	5.28	4.06	0.39	16.20	5825583
200 x 160	8 x 6	11	150	7.87	6.30	0.72	10.63	21.65	5.28	4.49	0.57	18.96	5825585
250 x 110	10 x 4	11	150	9.84	4.33	0.89	9.65	24.80	5.83	3.39	0.39	28.57	5825626
250 x 160	10 x 6	11	150	9.84	6.30	0.89	10.63	24.61	5.83	3.94	0.57	30.29	5825627
250 x 200	10 x 8	11	150	9.84	7.87	0.89	11.57	24.61	5.83	4.57	0.72	32.06	5825628
315 x 110	12 x 4	11	150	12.40	4.33	1.13	11.42	21.50	6.69	3.94	0.39	35.05	5825658
315 x 160	12 x 6	11	150	12.40	6.30	1.13	12.20	22.64	6.69	4.72	0.57	38.62	5825659
315 x 200	12 x 8	11	150	12.40	7.87	1.13	12.83	25.20	6.69	4.96	0.72	46.30	5825660
315 x 250	12 x 10	11	150	12.40	9.84	1.13	13.11	26.38	6.69	5.91	0.89	50.35	5825673

Note: Socket fusion couplings are required between components rated SDR 11 and SDR 7.4. Butt fusion only permitted where component SDR matches.

*The most current up-to-date drawings and CAD models can be found at <https://cad.asahi-america.com/>*

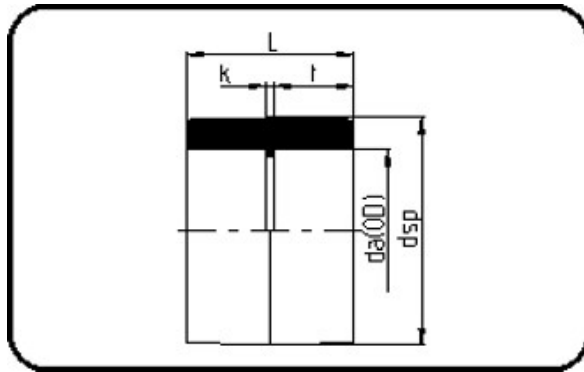

- Socket
- Injection molded
- Socket welding

### COUPLING

Size		Dimensions								Part Number
mm	inch	SDR	MOP (psi)	da(OD) (in)	L (in)	dsp (in)	t (in)	k (in)	Weight (lbs)	
20	1/2	7.4	230	0.79	1.38	1.16	0.63	0.12	0.03	5816005
25	3/4	7.4	230	0.98	1.54	1.38	0.71	0.12	0.04	5816007
32	1	7.4	230	1.26	1.69	1.70	0.79	0.12	0.06	5816010
40	1-1/4	7.4	230	1.57	1.89	2.01	0.83	0.26	0.08	5816012
50	1-1/2	7.4	230	1.97	2.07	2.54	0.94	0.18	0.14	5816015
63	2	7.4	230	2.48	2.38	3.19	1.10	0.18	0.26	5816020
75	2-1/2	7.4	230	2.95	2.76	3.64	1.32	0.12	0.34	5816025
90	3	7.4	230	3.54	3.07	4.53	1.42	0.24	0.65	5816030
110	4	7.4	230	4.33	3.54	5.26	1.69	0.24	0.84	5816040

*The most current up-to-date drawings and CAD models can be found at <https://cad.asahi-america.com/>*

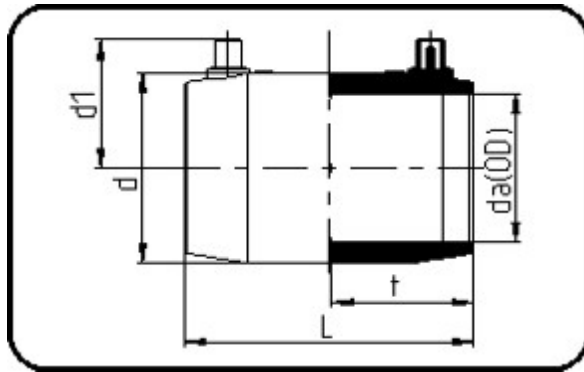

- E-coupler
- Injection molded
- Electrofusion

**AIR-PRO® ELECTROFUSION COUPLINGS**

Size		Dimensions								Part Number
mm	inch	SDR	MOP (psi)	da(OD) (in)	L (in)	d (in)	d1 (in)	t (in)	Weight (lbs)	
160	6	11-17	150	6.30	7.09	7.76	4.29	3.46	3.74	5817060
200	8	11-26	150	7.87	8.48	9.67	5.04	4.13	6.25	5817080
250	10	11-26	150	9.84	9.37	12.20	6.10	4.59	11.33	5817100
315	12	11-26	150	12.40	10.20	15.20	7.36	5.02	18.60	5817120

*The most current up-to-date drawings and CAD models can be found at <https://cad.asahi-america.com/>*

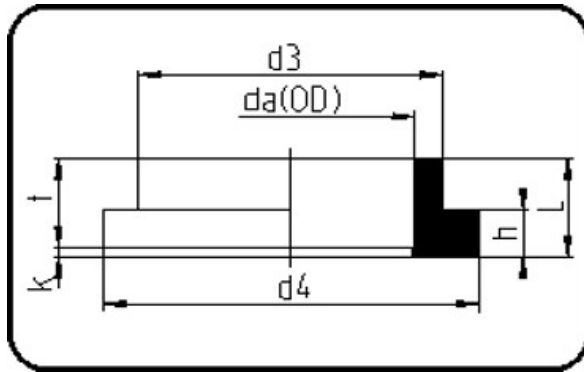

- Flange adapter
- Injection molded
- Socket welding

### STUB END

Size		Dimensions											Part Number
mm	inch	STD	SDR	MOP (psi)	da(OD) (in)	L (in)	d3 (in)	d4 (in)	h (in)	t (in)	k (in)	Weight (lbs)	
20	1/2	ANSI	7.4	230	0.79	0.83	1.06	1.75	0.39	0.61	0.22	0.03	5833005
25	3/4	ANSI	7.4	230	0.98	0.91	1.30	2.13	0.39	0.71	0.20	0.05	5833007
32	1	ANSI	7.4	230	1.26	0.93	1.61	2.50	0.39	0.75	0.19	0.07	5833010
40	1-1/4	ANSI	7.4	230	1.57	1.02	1.97	2.81	0.41	0.85	0.18	0.11	5833012
50	1-1/2	ANSI	7.4	230	1.97	1.14	2.40	3.25	0.51	0.94	0.20	0.13	5833015
63	2	ANSI	7.4	230	2.48	1.28	2.99	3.95	0.55	1.10	0.18	0.19	5833020
75	2-1/2	ANSI	7.4	230	2.95	1.50	3.54	4.61	0.63	1.20	0.30	0.33	5833025
90	3	ANSI	7.4	230	3.54	1.65	4.25	5.21	0.67	1.46	0.20	0.44	5833030
110	4	ANSI	7.4	230	4.33	1.85	5.16	6.22	0.71	1.65	0.20	0.64	5833040

Note: All sizes available with 6" pup for butt welding. Use PN 583301 + last 3 digits of selected size

*The most current up-to-date drawings and CAD models can be found at <https://cad.asahi-america.com/>*

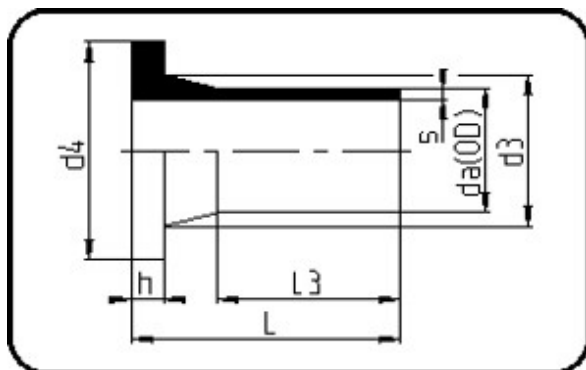

- Stub flange
- Long spigot
- Injection molded
- Butt & electrofusion welding

### ELONGATED STUB END

Size		Dimensions										Part Number	
mm	inch	STD	SDR	MOP (psi)	da(OD) (in)	s (in)	L (in)	L3 (in)	d3 (in)	d4 (in)	h (in)		Weight (lbs)
160	6	DIN	11	150	6.30	0.57	7.87	5.83	6.89	8.35	0.98	3.90	5832060
200	8	DIN	11	150	7.87	0.72	8.27	5.51	9.13	10.55	1.26	7.10	5832080
250	10	DIN	11	150	9.84	0.89	8.03	5.20	11.22	12.60	1.38	10.36	5832100
315	12	DIN	11	150	12.40	1.13	9.37	6.06	13.19	14.57	1.38	16.71	5832120

Note: Socket fusion couplings are required between components rated SDR 11 and SDR 7.4. Butt fusion only permitted where component SDR matches.

*The most current up-to-date drawings and CAD models can be found at <https://cad.asahi-america.com/>*



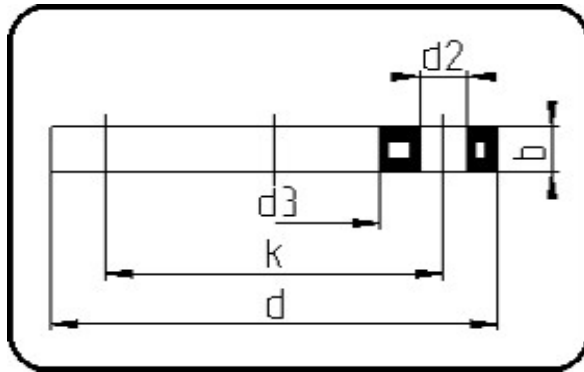

- Backing ring
- Steel insert
- Injection molded
- Flange connection

*Gasket max torque supercedes torques shown*

### BACKING RING

Size		Dimensions										Part Number	
mm	inch	STD	MOP (psi)	d (in)	d2 (in)	d3 (in)	b (in)	k (in)	Max Torque (ft-lbs)	Bolt Size (qty)	Weight (lbs)	PP-FRP	
												GREY	BLACK
20	1/2	ANSI	230	3.74	0.63	1.10	0.47	2.38	15	1/2 (4)	0.46	5046005	5146005
25	3/4	ANSI	230	4.02	0.63	1.34	0.47	2.75	15	1/2 (4)	0.51	5046007	5146007
32	1	ANSI	230	4.49	0.63	1.65	0.63	3.12	22	1/2 (4)	0.84	5046010	5146010
40	1-1/4	ANSI	230	5.12	0.63	2.01	0.63	3.50	22	1/2 (4)	1.23	5046012	5146012
50	1-1/2	ANSI	230	5.24	0.63	2.44	0.71	3.88	30	1/2 (4)	1.21	5046015	5146015
63	2	ANSI	230	6.38	0.79	3.07	0.71	4.75	37	5/8 (4)	1.79	5046020	5146020
75	2-1/2	ANSI	230	7.24	0.79	3.62	0.71	5.50	44	5/8 (4)	2.41	5046025	5146025
90	3	ANSI	230	7.64	0.79	4.37	0.71	6.00	41	5/8 (4)	2.34	5046030	5146030
110	4	ANSI	230	9.02	0.79	5.24	0.71	7.50	41	5/8 (8)	3.40	5046040	5146040
140	5	ANSI	230	10.16	0.87	6.22	0.94	8.50	63	3/4 (8)	4.96	5046050	5146050
160	6	ANSI	230	11.14	0.87	7.01	0.94	9.50	70	3/4 (8)	5.20	5046060	5146060
200	8	ANSI	230	13.58	0.87	9.29	0.94	11.75	89	3/4 (8)	8.58	5046080	5146080
250	10	ANSI	230	16.22	0.98	11.34	1.02	14.25	96	7/8 (12)	13.42	5046100	5146100
315	12	ANSI	230	19.17	0.98	13.31	1.26	17.00	96	7/8 (12)	28.53	5046120	5146120

*The most current up-to-date drawings and CAD models can be found at <https://cad.asahi-america.com/>*

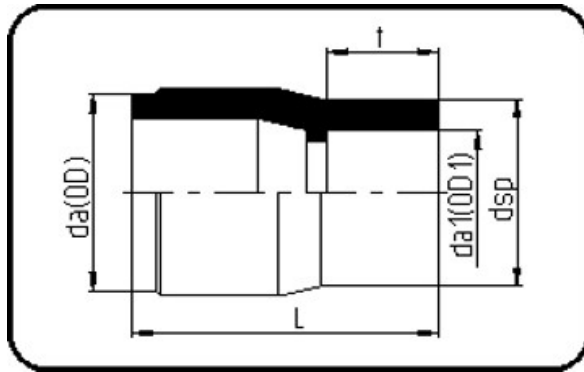

- Reducer concentric
- Injection molded
- Socket welding only

### CONCENTRIC REDUCER BUSHING

Size		Dimensions								Part Number
mm	inch	SDR	MOP (psi)	da(OD) (in)	da(OD1) (in)	L (in)	dsp (in)	t (in)	Weight (lbs)	
25 x 20	3/4 x 1/2	7.4	230	0.98	0.79	1.54	1.16	0.63	0.02	5829101
32 x 20	1 x 1/2	7.4	230	1.26	0.79	1.75	1.14	0.63	0.04	5829130
32 x 25	1 x 3/4	7.4	230	1.26	0.98	1.77	1.36	0.67	0.04	5829131
40 x 20	1-1/4 x 1/2	7.4	230	1.57	0.79	1.97	1.16	0.59	0.05	5829166
40 x 25	1-1/4 x 3/4	7.4	230	1.57	0.98	1.97	1.36	0.67	0.06	5829167
40 x 32	1-1/4 x 1	7.4	230	1.57	1.26	1.97	1.69	0.75	0.06	5829168
50 x 20	1-1/2 x 1/2	7.4	230	1.97	0.79	2.19	1.16	0.63	0.07	5829208
50 x 25	1-1/2 x 3/4	7.4	230	1.97	0.98	2.17	1.37	0.71	0.07	5829210
50 x 32	1-1/2 x 1	7.4	230	1.97	1.26	2.17	1.67	0.71	0.08	5829211
50 x 40	1-1/2 x 1-1/4	7.4	230	1.97	1.57	2.15	2.08	1.02	0.10	5829212
63 x 25	2 x 3/4	7.4	230	2.48	0.98	2.52	1.37	0.71	0.13	5829248
63 x 32	2 x 1	7.4	230	2.48	1.26	2.56	1.69	0.73	0.13	5829249
63 x 40	2 x 1-1/4	7.4	230	2.48	1.57	2.52	2.08	0.85	0.14	5829250
63 x 50	2 x 1-1/2	7.4	230	2.48	1.97	2.56	2.55	0.98	0.17	5829251
75 x 50	2-1/2 x 1-1/2	7.4	230	2.95	1.97	3.43	2.56	0.96	0.31	5829291
75 x 63	2-1/2 x 2	7.4	230	2.95	2.48	2.52	3.21	1.14	0.22	5829292
90 x 63	3 x 2	7.4	230	3.54	2.48	3.41	3.18	1.14	0.40	5829338
90 x 75	3 x 2-1/2	7.4	230	3.54	2.95	3.41	3.66	1.26	0.43	5829339
110 x 63	4 x 2	7.4	230	4.33	2.48	3.54	3.20	1.14	0.59	5829420
110 x 90	4 x 3	7.4	230	4.33	3.54	3.46	4.45	1.46	0.68	5829422

Note: All sizes available with 6" pup for butt welding. Use PN 583301 + last 3 digits of selected size

**The most current up-to-date drawings and CAD models can be found at <https://cad.asahi-america.com/>**

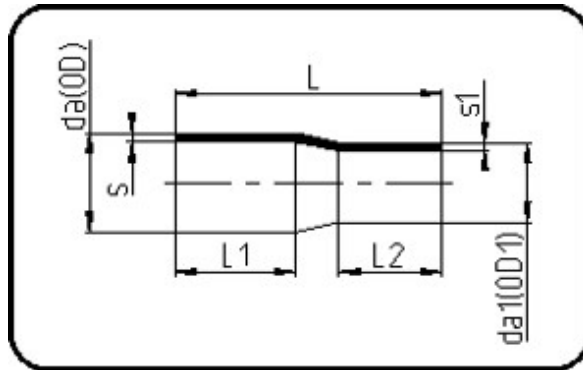

- Reducer concentric
- Long spigot
- Injection molded
- Butt & electrofusion welding

**ELONGATED CONCENTRIC REDUCER**

Size		Dimensions										Part Number
mm	inch	SDR	MOP (psi)	da(OD) (in)	da(OD1) (in)	s (in)	L (in)	L1 (in)	L2 (in)	s1 (in)	Weight (lbs)	
160 x 90	6 x 3	11	150	6.30	3.54	0.57	8.54	3.96	3.11	0.32	2.23	5831531
160 x 110	6 x 4	11	150	6.30	4.33	0.57	8.74	3.86	3.46	0.39	2.51	5831532
200 x 160	8 x 6	11	150	7.87	6.30	0.72	9.92	4.41	3.88	0.57	4.96	5831585
250 x 160	10 x 6	11	150	9.84	6.30	0.89	12.36	6.04	4.39	0.57	8.77	5831627
250 x 200	10 x 8	11	150	9.84	7.87	0.89	12.36	6.04	4.86	0.72	9.79	5831628
315 x 200	12 x 8	11	150	12.40	7.87	1.13	14.76	6.99	5.18	0.72	16.84	5831660
315 x 250	12 x 10	11	150	12.40	9.84	1.13	14.76	6.83	6.04	0.89	18.34	5831673

Note: Socket fusion couplings are required between components rated SDR 11 and SDR 7.4. Butt fusion only permitted where component SDR matches.

*The most current up-to-date drawings and CAD models can be found at <https://cad.asahi-america.com/>*

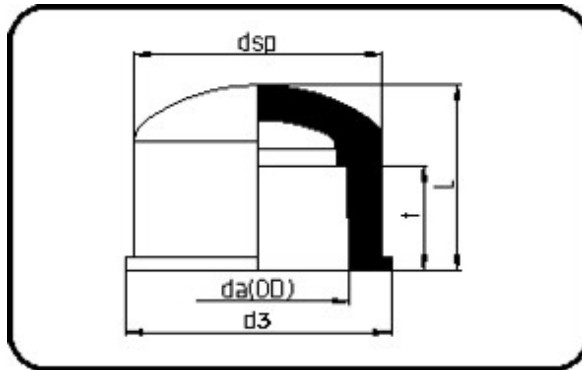

- End cap
- Injection molded
- Socket welding

**END CAP**

Size		Dimensions								Part Number
mm	inch	SDR	MOP (psi)	da(OD) (in)	L (in)	d3 (in)	dsp (in)	t (in)	Weight (lbs)	
20	1/2	7.4	230	0.79	1.02	1.26	1.14	0.63	0.02	5812005
25	3/4	7.4	230	0.98	1.12	1.50	1.38	0.71	0.03	5812007
32	1	7.4	230	1.26	1.38	1.81	1.69	0.79	0.05	5812010
40	1-1/4	7.4	230	1.57	1.54	2.28	2.07	0.87	0.08	5812012
50	1-1/2	7.4	230	1.97	1.91	2.76	2.54	0.96	0.14	5812015
63	2	7.4	230	2.48	2.32	3.41	3.19	1.14	0.29	5812020
75	2-1/2	7.4	230	2.95	2.64	3.86	3.64	1.26	0.35	5812025
90	3	7.4	230	3.54	3.03	4.69	4.45	1.46	0.64	5812030
110	4	7.4	230	4.33	3.60	5.51	5.24	1.67	0.97	5812040

*The most current up-to-date drawings and CAD models can be found at <https://cad.asahi-america.com/>*

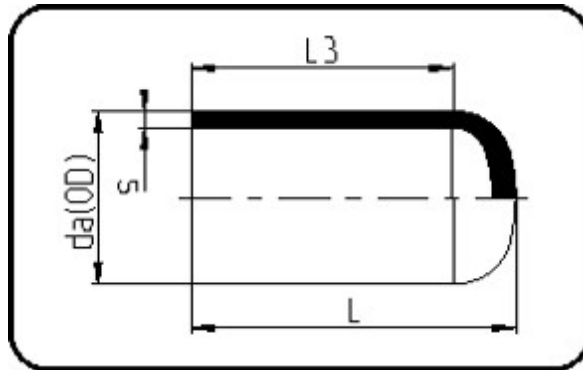

- End cap
- Long spigot
- Injection molded
- Butt & electrofusion welding

**ELONGATED END CAP**

Size		Dimensions							Part Number
mm	inch	SDR	MOP (psi)	da(OD) (in)	s (in)	L (in)	L3 (in)	Weight (lbs)	
160	6	11	150	6.30	0.57	6.50	4.86	2.65	5813060
200	8	11	150	7.87	0.72	7.15	4.61	4.41	5813080
250	10	11	150	9.84	0.89	8.78	6.30	8.49	5813100
315	12	11	150	12.40	1.13	10.59	6.57	15.60	5813120

Note: Socket fusion couplings are required between components rated SDR 11 and SDR 7.4. Butt fusion only permitted where component SDR matches.

*The most current up-to-date drawings and CAD models can be found at <https://cad.asahi-america.com/>*

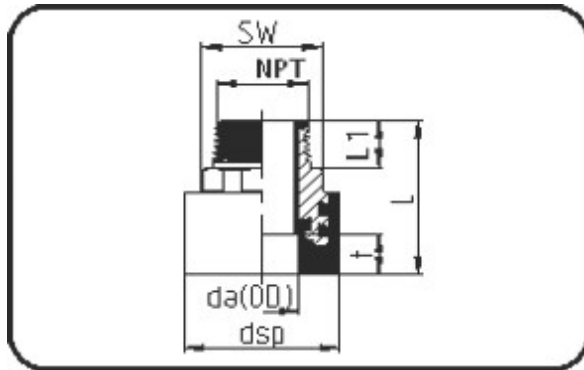

- Adapter
- NPT metal male thread + hexag.
- Injection molded
- Socket welding

### MALE ADAPTER

Size		Dimensions										Part Number
mm	inch	SDR	MOP (psi)	da(OD) (in)	L (in)	L1 (in)	SW (in)	NPT (in)	dsp (in)	t (in)	Weight (lbs)	
20	1/2	7.4	230	0.79	2.24	0.61	1.26	1/2	1.65	0.63	0.35	5859005
25	3/4	7.4	230	0.98	2.40	0.77	1.42	3/4	1.81	0.71	0.46	5859007
32	1	7.4	230	1.26	2.50	0.87	1.54	1	2.09	0.73	0.57	5859010
40	1-1/4	7.4	230	1.57	2.80	0.94	1.97	1-1/4	2.58	0.83	1.06	5859012
50	1-1/2	7.4	230	1.97	3.03	1.06	2.36	1-1/2	2.99	0.94	1.44	5859015
63	2	7.4	230	2.48	3.27	1.14	2.76	2	3.52	1.12	2.08	5859020

*The most current up-to-date drawings and CAD models can be found at <https://cad.asahi-america.com/>*

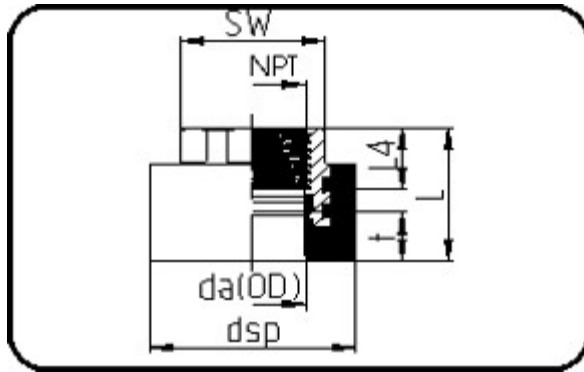

- Adapter
- NPT metal female thread + hexag.
- Injection molded
- Socket welding

### FEMALE ADAPTER

Size		Dimensions										Part Number
mm	inch	SDR	MOP (psi)	da(OD) (in)	L (in)	L1 (in)	SW (in)	NPT (in)	dsp (in)	t (in)	Weight (lbs)	
20	1/2	7.4	230	0.79	1.61	0.55	1.26	1/2	1.65	0.57	0.31	5853005
25	3/4	7.4	230	0.98	1.61	0.71	1.42	3/4	1.81	0.63	0.35	5853007
32	1	7.4	230	1.26	1.81	0.79	1.54	1	2.09	0.73	0.47	5853010
40	1-1/4	7.4	230	1.57	2.01	0.83	1.97	1-1/4	2.58	0.83	0.76	5853012
50	1-1/2	7.4	230	1.97	2.28	1.00	2.36	1-1/2	3.05	0.94	1.30	5853015
63	2	7.4	230	2.48	2.56	1.14	2.76	2	3.56	1.14	1.70	5853020

*The most current up-to-date drawings and CAD models can be found at <https://cad.asahi-america.com/>*

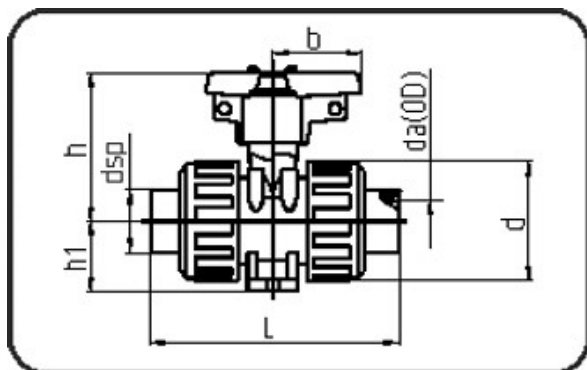

- Ball valve M1
- FPM sealing
- Injection molded
- Socket welding

### BALL VALVE - M1 STYLE W/ MOUNTING PADS

Size		Dimensions											Part Number
mm	inch	SDR	MOP (psi)	da(OD) (in)	L (in)	d (in)	h (in)	b (in)	h1 (in)	dsp (in)	t (in)	Weight (lbs)	
20	1/2	7.4	230	0.79	3.88	2.28	2.93	1.57	1.30	1.07	0.63	0.39	580117005
25	3/4	7.4	230	0.98	4.45	2.70	3.27	2.03	1.57	1.41	0.67	0.60	580117007
32	1	7.4	230	1.26	4.84	2.97	3.37	2.03	1.71	1.63	0.77	0.66	580117010
40	1-1/4	7.4	230	1.57	5.55	3.62	4.11	2.52	2.01	2.08	0.87	1.10	580117012
50	1-1/2	7.4	230	1.97	6.50	4.25	4.45	2.87	2.22	2.31	0.98	1.83	580117015
63	2	7.4	230	2.48	7.66	5.02	4.78	3.35	2.54	2.90	1.14	2.77	580117020

The most current up-to-date drawings and CAD models can be found at <https://cad.asahi-america.com/>



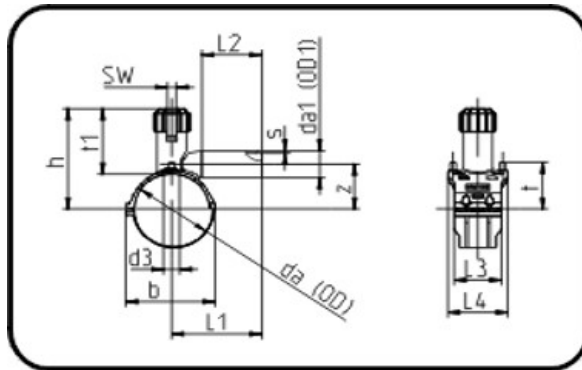

- Tapping saddle with screw cap
- Injection molded
- Electrofusion welding

**ELECTROFUSION TAPPING SADDLE**

Size		Dimensions																Part Number	
mm	inch	SDR	MOP (psi)	da(OD) (in)	da(OD1) (in)	s (in)	z (in)	L1 (in)	L2 (in)	L3 (in)	L4 (in)	d3 (in)	h (in)	b (in)	SW (in)	t (in)	t1 (in)		Weight (lbs)
63 x 20	2 x 1/2	11	150	2.48	0.79	0.12	2.36	4.72	3.07	4.02	4.69	1.02	6.67	3.90	0.39	2.34	5.43	1.19	5839246
63 x 32	2 x 1	11	150	2.48	1.26	0.12	2.24	5.08	3.62	4.02	4.69	1.02	6.67	3.90	0.39	2.34	5.43	1.23	5839249
63 x 40	2 x 1-1/4	11	150	2.48	1.57	0.15	2.30	5.55	4.02	4.02	4.69	1.02	6.67	3.90	0.39	2.34	5.43	1.28	5839250
63 x 63	2 x 2	11	150	2.48	2.48	0.23	2.36	7.01	5.12	4.02	4.69	1.02	6.67	3.90	0.39	2.34	5.43	1.52	5839020
90 x 32	3 x 1	11-17	150	3.54	1.26	0.12	2.64	5.12	3.62	4.06	5.12	1.26	7.74	5.04	0.67	2.87	5.98	1.67	5839336
90 x 63	3 x 2	11-17	150	3.54	2.48	0.23	2.64	7.24	5.12	4.06	5.12	1.26	7.74	5.04	0.67	2.87	5.98	1.36	5839338
110 x 20	4 x 1/2	11-17	150	4.33	0.79	0.12	2.99	4.72	3.07	4.06	5.12	1.26	8.13	5.87	0.67	3.27	5.98	1.79	5839399
110 x 32	4 x 1	11-17	150	4.33	1.26	0.12	2.99	5.16	3.74	4.06	5.12	1.26	8.13	5.87	0.67	3.27	5.98	1.76	5839401
110 x 40	4 x 1-1/4	11-17	150	4.33	1.57	0.15	2.99	5.94	4.02	4.06	5.12	1.26	8.13	5.87	0.67	3.27	5.98	1.84	5839412
110 x 63	4 x 2	11-17	150	4.33	2.48	0.23	3.25	7.28	5.12	4.06	5.12	1.26	8.13	5.87	0.67	3.27	5.98	2.08	5839420
160 x 20	6 x 1/2	11-17	150	6.30	0.79	0.12	3.88	4.76	3.07	4.06	5.16	1.26	9.11	8.03	0.67	4.25	5.98	1.87	5839512
160 x 32	6 x 1	11-17	150	6.30	1.26	0.12	3.90	5.12	3.62	4.06	5.16	1.26	9.11	8.03	0.67	4.25	5.98	1.96	5839516
160 x 40	6 x 1-1/4	11-17	150	6.30	1.57	0.15	4.07	5.83	4.02	4.06	5.16	1.26	9.11	8.03	0.67	4.25	5.98	2.05	5839519
160 x 63	6 x 2	11-17	150	6.30	2.48	0.23	4.04	7.80	5.12	4.06	5.16	1.26	9.11	8.03	0.67	4.25	5.98	2.25	5839530
200 x 63	8 x 2	11-17	150	7.87	2.48	0.23	4.80	7.80	5.12	4.02	5.59	1.26	9.90	9.96	0.67	5.04	5.98	2.47	5839581
250 x 63	10 x 2	11-17	150	9.84	2.48	0.23	5.94	8.15	5.12	4.02	5.59	1.26	11.69	10.45	0.67	5.53	7.24	2.86	5839624
315 x 63	12 x 2	11-17	150	12.40	2.48	0.23	7.15	8.46	5.12	4.09	5.67	1.26	13.46	15.35	0.67	7.28	7.24	2.82	5839656

The most current up-to-date drawings and CAD models can be found at <https://cad.asahi-america.com/>

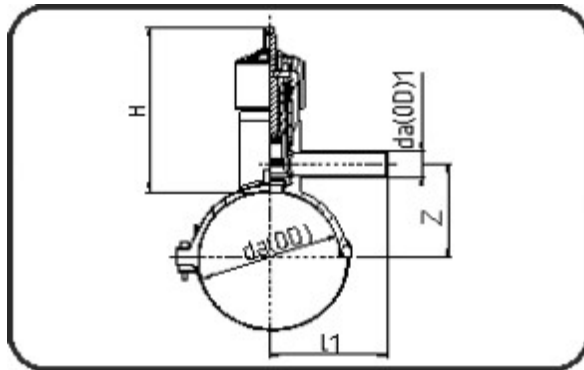

- Pressure tapping valve
- Brass valve & integrated cutter
- Injection molded
- Electrofusion welding

**ELECTROFUSION TAPPING SADDLE WITH VALVE**

Size		Dimensions								Part Number
mm	inch	SDR	MOP (psi)	da(OD) (in)	L1 (in)	h (in)	z (in)	da(OD1) (in)	Weight (lbs)	
63 x 32	2 x 1	11	150	2.48	5.16	6.42	2.57	1.26	3.53	5838249
63 x 40	2 x 1-1/4	11	150	2.48	5.51	6.42	2.57	1.57	3.48	5838250
63 x 50	2 x 1-1/2	11	150	2.48	6.32	6.42	2.57	1.97	3.63	5838251
63 x 63	2 x 2	11	150	2.48	7.36	6.42	2.57	2.48	3.77	5838020
90 x 32	3 x 1	11-17	150	3.54	5.31	7.99	3.11	1.26	5.25	5838336
90 x 40	3 x 1-1/4	11-17	150	3.54	5.71	7.99	3.11	1.57	5.31	5838335
90 x 50	3 x 1-1/2	11-17	150	3.54	6.34	7.99	3.11	1.97	5.38	5838337
90 x 63	3 x 2	11-17	150	3.54	7.56	7.99	3.11	2.48	5.47	5838338
110 x 32	4 x 1	11-17	150	4.33	5.39	7.95	3.43	1.26	5.42	5838401
110 x 40	4 x 1-1/4	11-17	150	4.33	5.79	7.99	3.43	1.57	5.51	5838412
110 x 50	4 x 1-1/2	11-17	150	4.33	6.30	7.99	3.43	1.97	5.46	5838415
110 x 63	4 x 2	11-17	150	4.33	7.58	7.99	3.43	2.48	5.64	5838420
160 x 32	6 x 1	11-17	150	6.30	5.39	7.99	4.07	1.26	5.62	5838516
160 x 40	6 x 1-1/4	11-17	150	6.30	5.79	7.99	4.46	1.57	5.64	5838519
160 x 50	6 x 1-1/2	11-17	150	6.30	6.34	7.99	4.46	1.97	5.73	5838523
160 x 63	6 x 2	11-17	150	6.30	7.44	7.99	4.46	2.48	5.91	5838530
200 x 32	8 x 1	11-17	150	7.87	5.39	7.99	5.28	1.26	5.52	5838571
200 x 40	8 x 1-1/4	11-17	150	7.87	5.75	7.99	5.28	1.57	5.51	5838565
200 x 50	8 x 1-1/2	11-17	150	7.87	6.26	7.99	5.28	1.97	5.62	5838580
200 x 63	8 x 2	11-17	150	7.87	7.52	7.99	5.28	2.48	5.78	5838581
250 x 63	10 x 2	11-17	150	9.84	8.84	7.99	6.68	2.48	5.50	5838624
315 x 63	12 x 2	11-17	150	12.40	7.56	7.99	8.02	2.48	6.17	5838656

*The most current up-to-date drawings and CAD models can be found at <https://cad.asahi-america.com/>*