

Duo-Pro® - PP, PVDF, E-CTFE

The premier double containment piping system offered on the market today, Duo-Pro® has been successfully installed in semiconductor, pharmaceutical and chemical processing industries.

Duo-Pro® offers maximum versatility to meet the unique requirements of each individual application. Our mix and match feature allows system designers to specify pipe material and ratings based on media and pressure changes throughout an entire system. Duo-Pro® components are shipped fully fabricated and ready for installation or can be factory prefabricated by trained welding professionals.

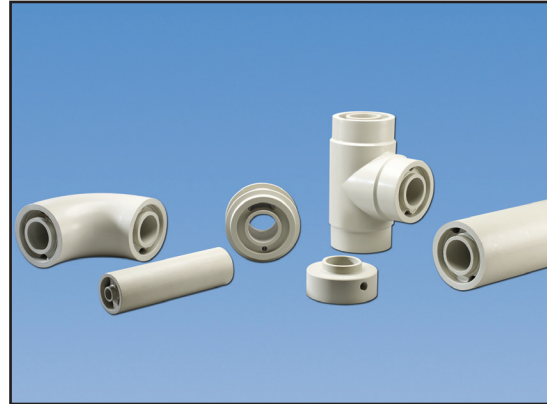

Supply Range

Standard Sizes: 1x3 through 24x32

Materials: Proline® PP-R, Super Proline® PVDF, Ultra Proline® ECTFE

Welding Methods:

Simultaneous or staggered butt fusion, Electrofusion

Features and Benefits

- Fabricated system made from extruded pipe and primarily molded fittings.
- Complete range of molded pressure fittings that are fabricated at the factory into double containment fittings.
- Designed to provide sufficient space for the installation of leak detection cable.
- Dogbones® provide the option for a compartmentalized system (solid Dogbones®), or a restrained system (restraint Dogbone®).

Sample Specification

System shall be a double containment piping system of suitable materials and pressure rating as specified. System product pipe shall be capable of transporting stated media under continuous exposure for 50 years. System containment pipe shall be capable of transporting/ holding stated media, in the event of failure of product pipe, for a minimum of 30 days.

Please consult Asahi/America for expanded product sample specification.

Why Choose Duo-Pro®?

Duo-Pro® has been created to solve all the previously encountered problems in double containment piping.

The system uses proven, highly corrosion resistant materials such as copolymer polypropylene, Super Proline PVDF and Halar® (ECTFE).

Fluids can be pumped through the carrier pipe up to 150psi.

Leak detection cable can be easily installed in sizes 3x6 and higher.

Duo-Pro® Ideal Applications

- Drainage applications
- Pressurized transfer lines
- Manufacturing
- Underground installations

